

# User Manual

## for Smart Deadbolt

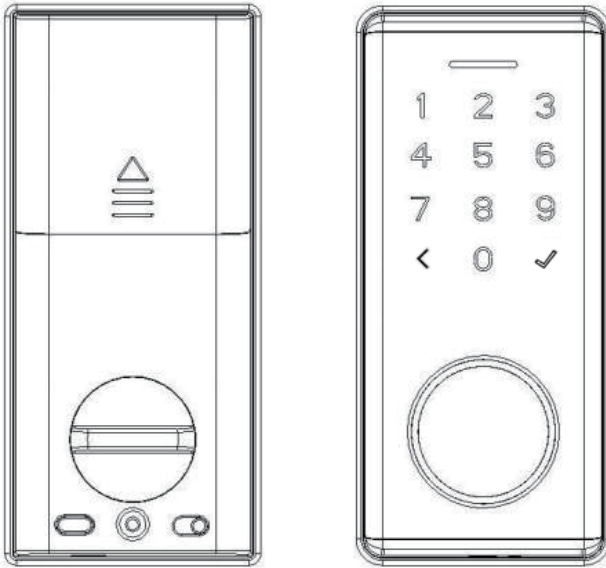

Thank you for your purchase. Please read this user manual before operating your smart lock, and keep it for further reference.

Powered by **BBEN Smart Home**

## Warm Notice

- © There are some differences between the left-side and right-side door. Check your door orientation and switch the toggle to the appropriate orientation.

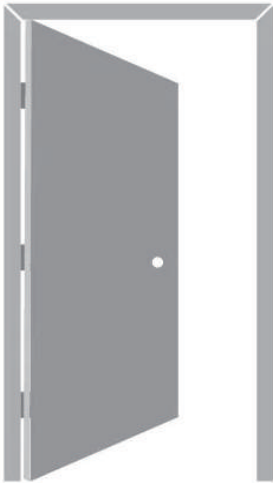

**LEFT HAND**

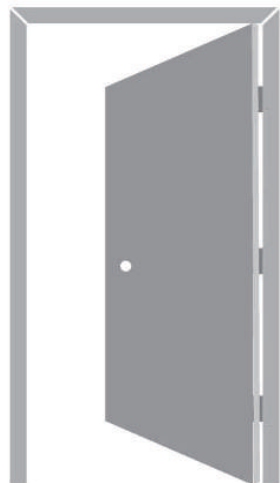

**RIGHT HAND**

## Product Design

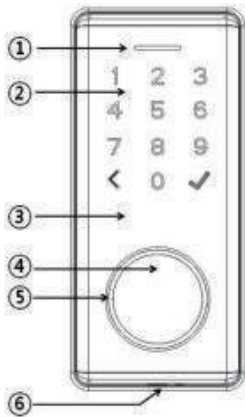

- ① Indicator light
- ② Touch keyboard
- ③ Acrylic
- ④ Cylinder cover
- ⑤ Pin
- ⑥ USB port(inside)
- ⑦ Battery cover

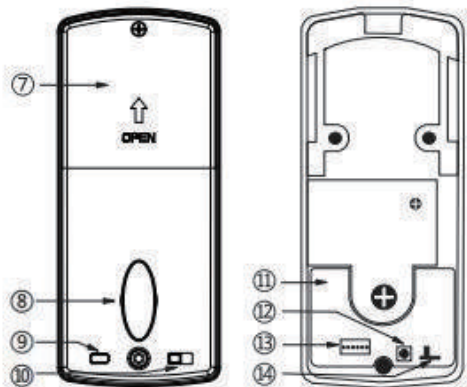

- ⑧ Knob
- ⑨ Button for locking & unlocking
- ⑩ Security switch
- ⑪ Rear PC board
- ⑫ Reset button
- ⑬ Socket
- ⑭ Switch for direction

## Installation

### Step 1 Adjustable deadbolt length

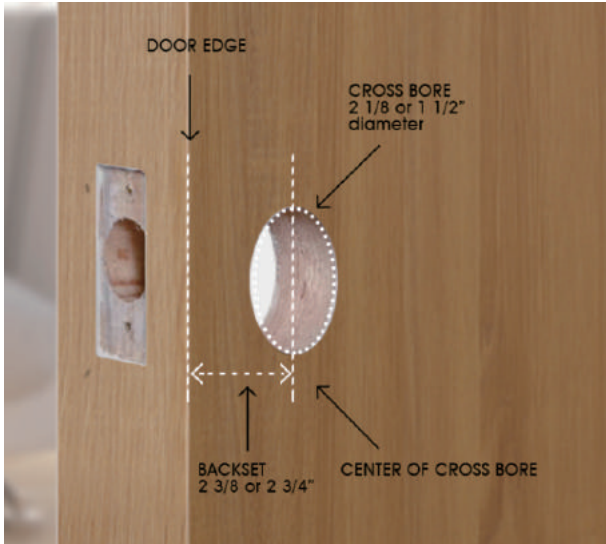

If backset of door measures 2 3/4" (70mm), adjust latch by rotating face as shown.

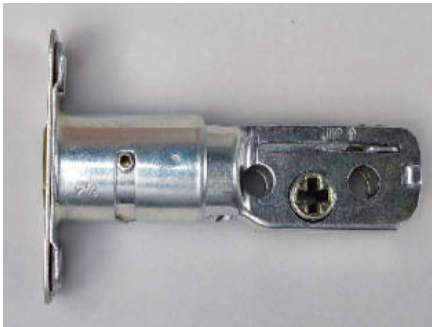

2-3/8" (60mm)

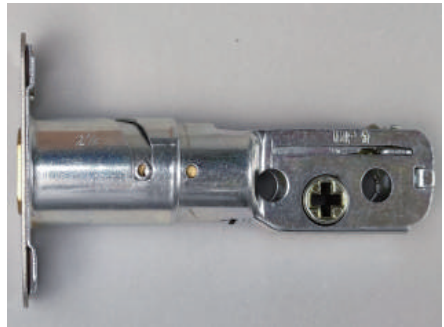

2-3/4" (70mm)

## Installing the deadbolt



'up' is upward



Affix with pointed screws

## Step 2 Installing the front panel

Keep the pin of the cylinder vertical and insert the keypad into the latch.

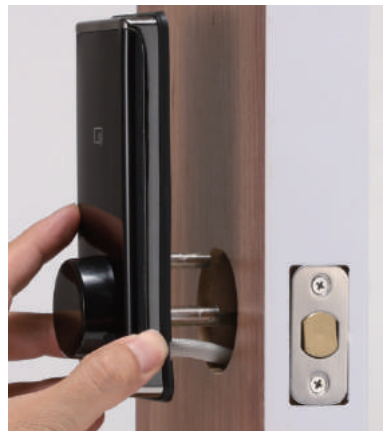

### Step 3 Installing the mounting plate

Keep the pin of the cylinder vertical and insert the keypad into the latch.

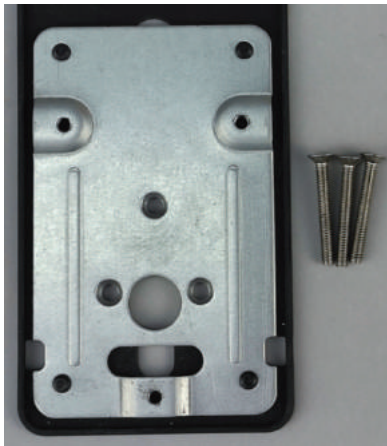

## Step 4 Adjusting the knob to the proper orientation

○ Switch the toggle switch to L/R based on your door orientation

Switch to L for a left-sided door / Switch to R for a right-sided door

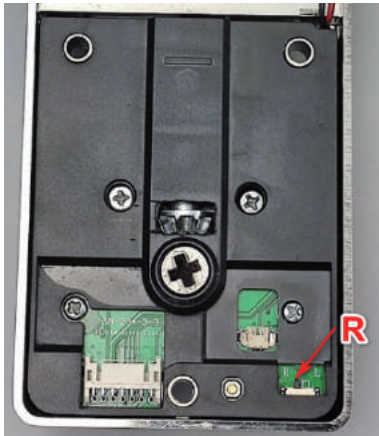

Right-sided door



Vertical for Right-side door

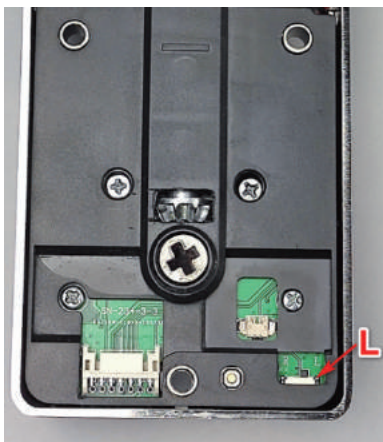

Left-sided door



Horizontal for Left-side door

Connect the IC wire to inside back panel



### **Step 5 Install inside back panel**

screw inside back panel to mounting plate (Demonstration of the right door)





## **Step 6 Install 4pcs AA batteries, screw back the battery cover**

screw inside back panel to mounting plate (Demonstration of the right door)

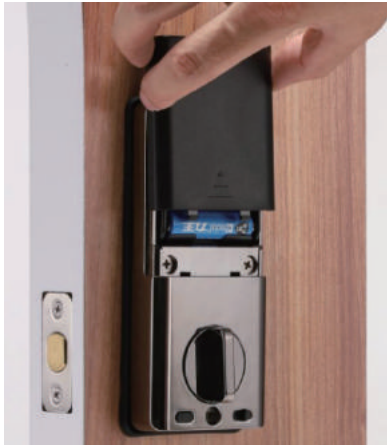

Remark: After installation completed, please check if the keypad light on by touching the keypad, if not, please check the connection of the IC wire or change new batteries.

## Operation by APP via Bluetooth

### Part 1 Add lock

©Download and install TLock from Google Play or APP Store



Google Play



APP Store

©Register account with phone number or e-mail and login

The screenshot shows the TLock app's registration interface. At the top, there are 'Login' and 'Register' buttons, with 'Register' highlighted in a red box. Below this, there are two tabs: 'Phone' and 'Email'. The 'Phone' tab is selected. The registration form includes fields for 'Phone number/Email', 'Password' (with a strength indicator), and 'Confirm Password'. There is also a 'Verification Code' field and a 'Get Code' button. A 'Login' button is visible at the bottom left, and a 'Forgot Password?' link is below it. A 'Register' button is at the bottom center. On the right side, there is a large circular icon with a plus sign. Below this icon, a note states: 'The Phone needs to be within 2 meters of the Smart Lock during the Pairing process.'

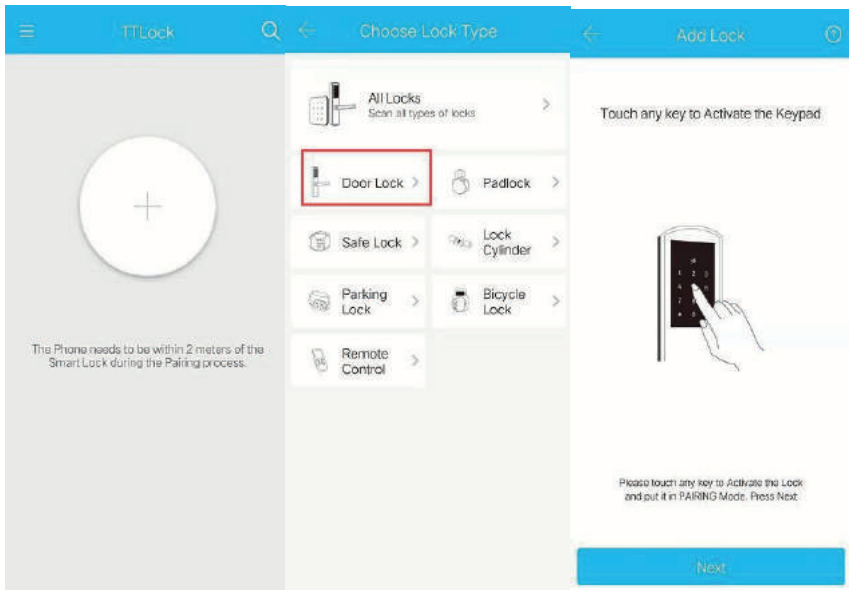

Click '+' in the center

Select 'Door Lock'

Touch keypad and click 'Next'

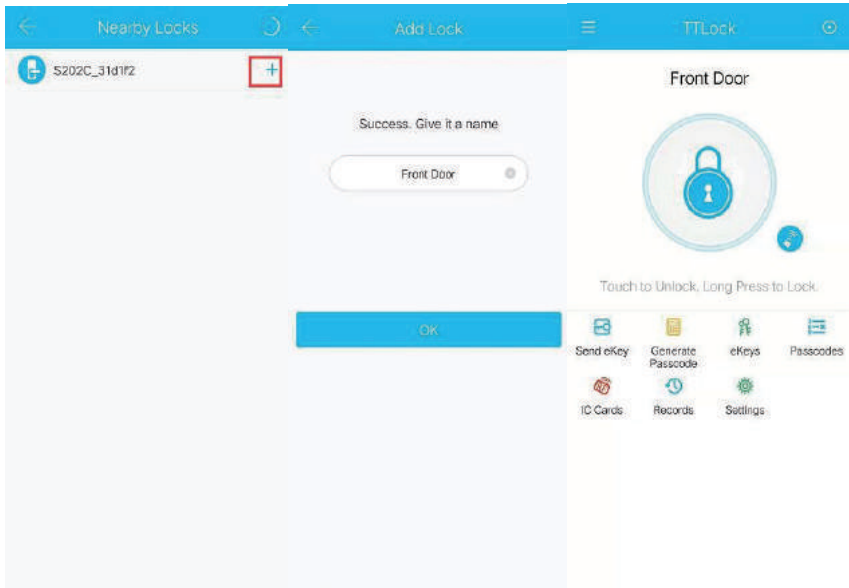

Click '+' with high-light device Name your lock, and click 'OK' Add completed

## Part 2 Unlock/lock by APP via Bluetooth

- Unlock by touching the lock button, it will pop up 'unlocked'
- Lock by long-pressing the lock button, it will pop up 'locked'

Remarks: Check to see if your door lock operates in the correct orientation. If it does not switch the toggle switch to other side and re-install it

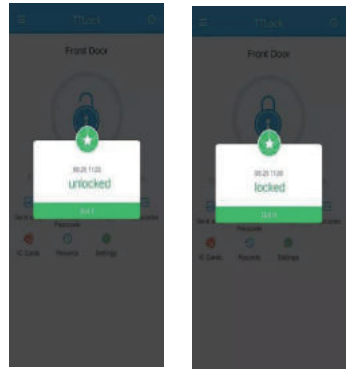

## Part 3 Auto-lock settings

Remarks: Auto-lock can only be set through the program, but cannot inform you if your door is locked. Keep your phone while setting up the lock.

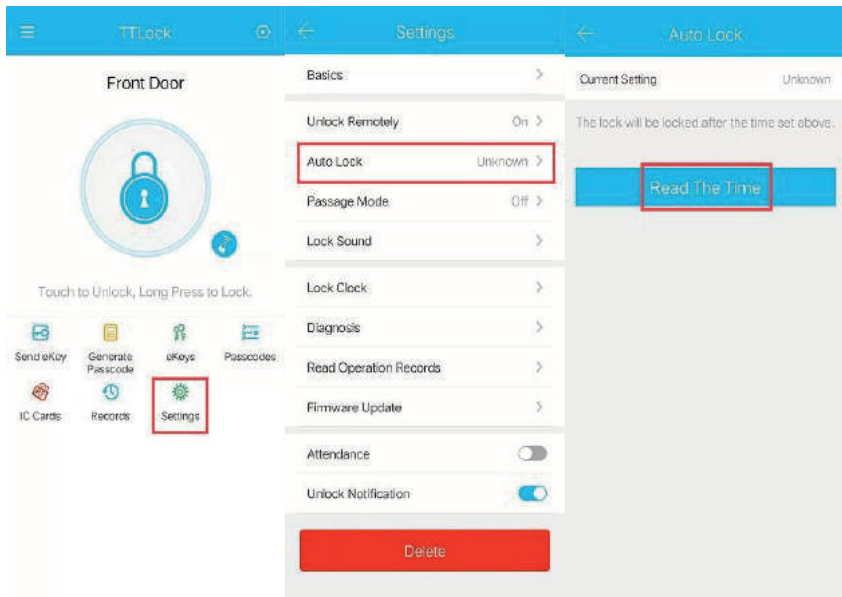

Click 'Settings'

Click 'Auto Lock'

Click 'Read the Time'

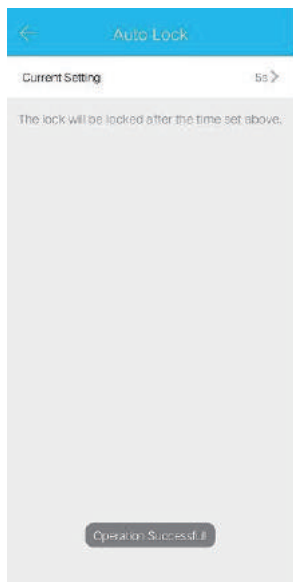

Click 'Current Settings'

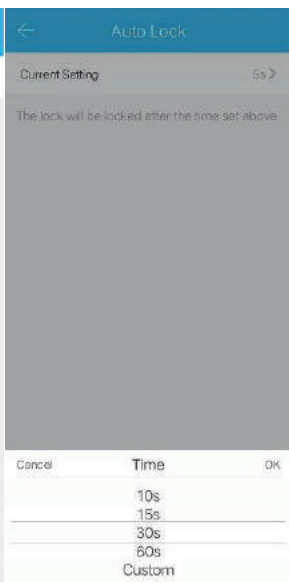

Select the duration best for you

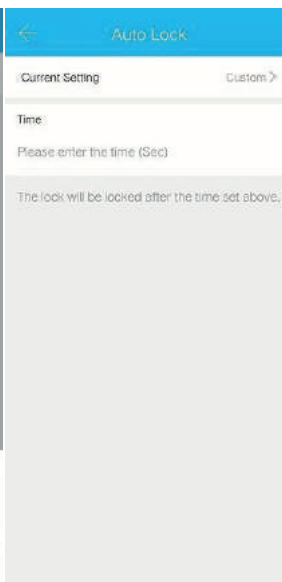

Or enter a custom one



Choose between 5 and 900 seconds

Set up complete!

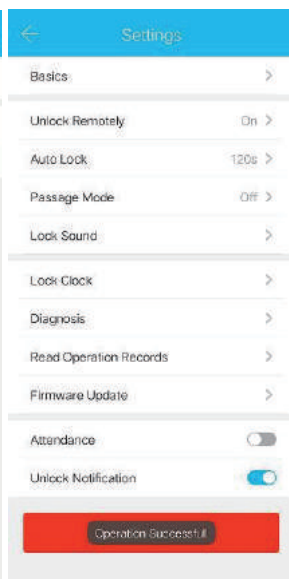

## Part 4 Share the app with your family/guests (eKey)

eKey is the function that authorizes your family members and guests to unlock/lock your door with the same app. eKey can be authorized to up to 20 smart phone users.

○ Download the TLock app and register a new account on other people's phones.

○ Click 'Send eKey' on the app screen with the admin account (the first account to add the lock).

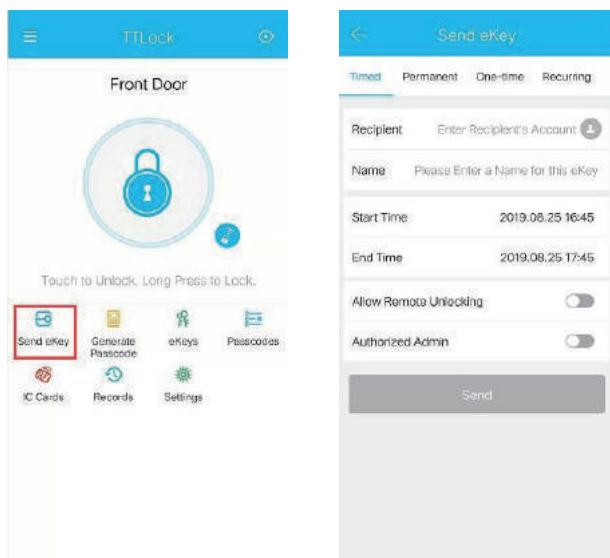

○ Select a Timed, Permanent, One-time, or Recurring eKey, then input the recipient account and name it.

○ Select duration if necessary, then click 'Send'.

○ Refresh by pulling down on the APP screen on the new smart phone app, and the smart lock will show up on the app screen.

Remarks: Admin accounts can manage all guest accounts by tapping on 'eKeys' in the app.

## Part 5 Lock Sound

The original settings for this smart lock is 'Lock Sound On', but you can disable it if you want.

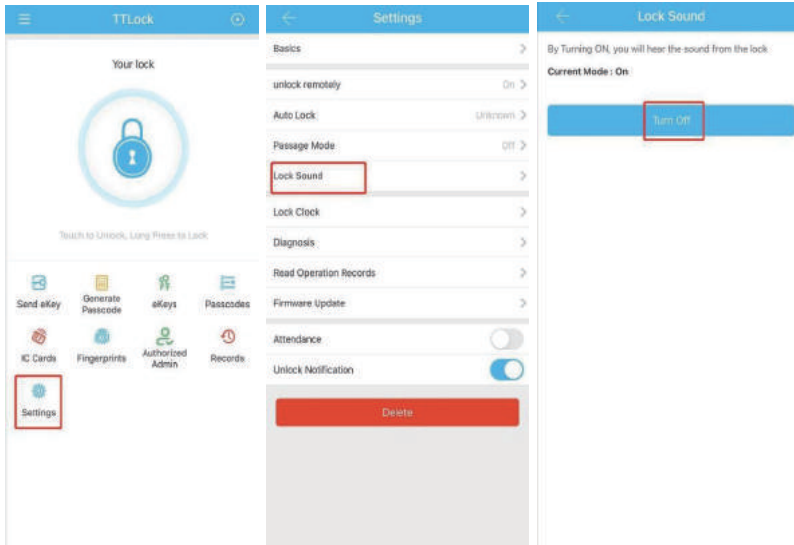

Click 'Settings'

Click 'Lock Sound'

Click 'Turn Off'

**Note:** Please keep your phone close while setting up your lock.

# Keypad Instructions

## Part 1 Generate Passcode

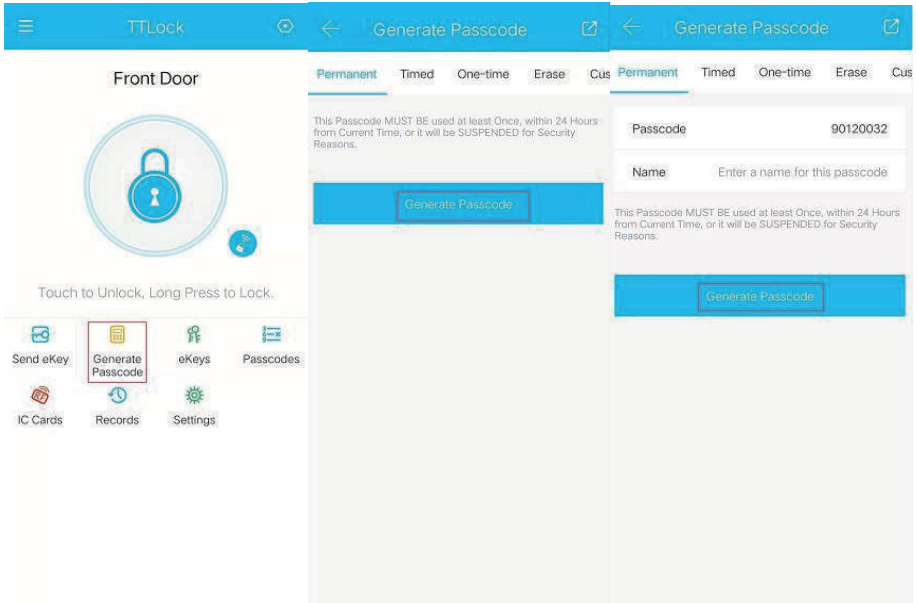

Click 'Generate Passcode' in the app

Select the type

Passcode generated

## Part 2 Unlock/lock with keypad

○ Unlock by inputting the passcode, then press the lock button

○ Lock by long-pressing the lock button

**Note:** For your safety, this smart lock supports Virtual Passcode (add any digit in front of or behind the passcode. If your Passcode is 12345678, you can unlock it with 5612345678 or 1234567802.



# IC Card Instructions

IC Card can be used to unlock your door but cannot be used to lock it.

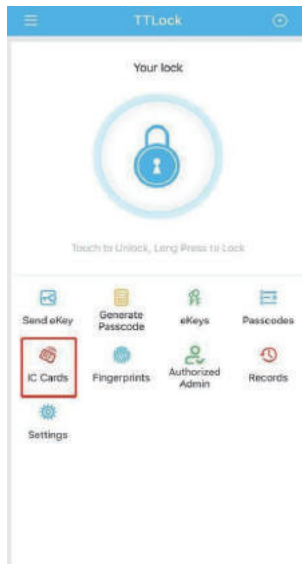

Tap 'IC Cards' in the app

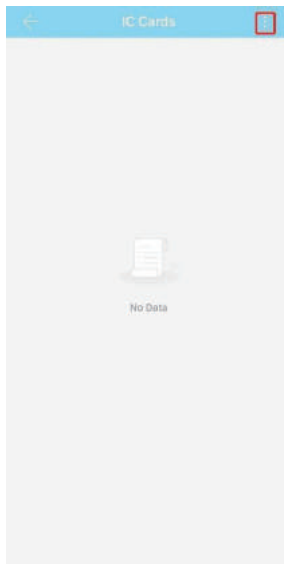

Click ' ' in the upper right corner

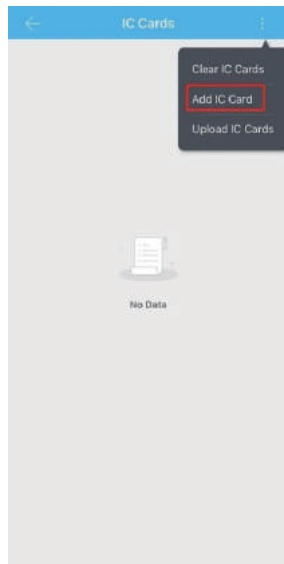

Tap 'Add IC Card'

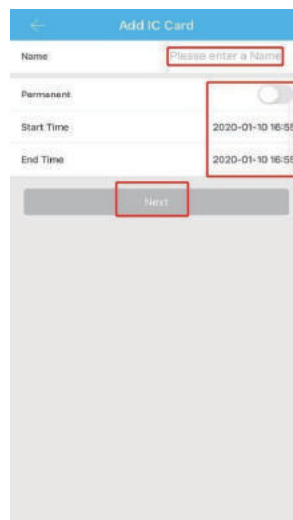

Name it and select the duration



Wait for it to connect



Connected



Place the IC Card on the keypad, and you're done

**Note:** Keep your phone nearby while setting up your lock.

## Mechanical Key Instructions

There are two compatible mechanical keys included. Please keep them available for backup.

- Take the cover off by turning the cover
- Insert the keys to unlock/lock your door

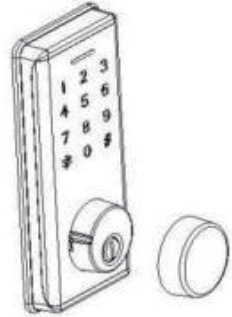

## App Wi-Fi Instructions

The lock is compatible with a Bluetooth Wi-Fi gateway (sold separately). To enable this functionality, you can search for Smart Wi-Fi Gateway and buy it on [www.amazon.com](http://www.amazon.com)

Note: Refer to the instructions that come with the Wi-Fi Gateway for more thorough information about how to set up and operate the device.

- Unlock by touching the little button
- Lock by long-pressing the same lock button with Bluetooth local controls enabled



## Other Functions

### Alarms

**Anti-theft Alarm:** Once someone enters the passcode incorrectly five times, it will lock for 5 minutes, and no one can get in, even if you enter the correct passcode..

**Low Voltage Alarm:** Once the batteries are almost dead, this smart lock will send an alert, and if you forget to replace the batteries before they are dead, you can use USB backup power to power it (at the bottom of keypad).

### Security Lock

The Security Switch is under the knob, and only the Manager Passcode can unlock when you switch it to ON. It also can't be locked through the keypad.

### Part 3 Passage Mode

During a preset duration, this smart lock will remain unlocked until it is manually locked once Passage Mode is activated

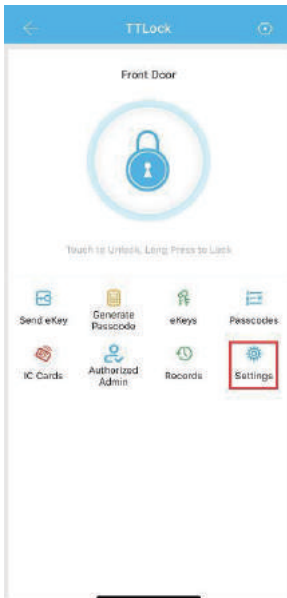

Click 'Settings'

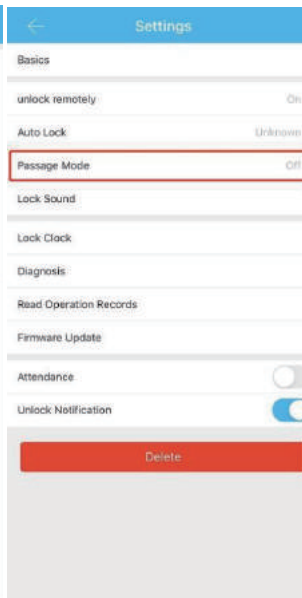

Click 'Passage Mode'

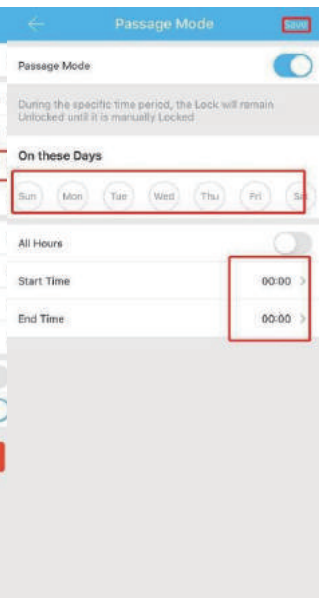

Activate Passage Mode

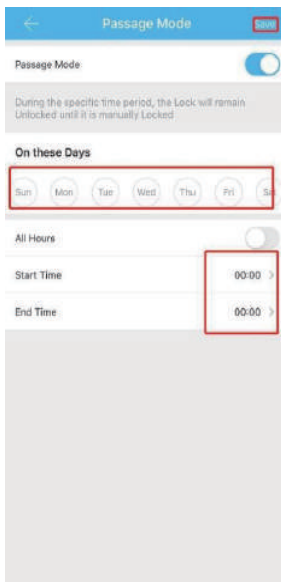

Select period and click 'Save'

## Warranty

You will be 100% satisfied. We provide a refund 30 days after purchase and 90 days to replace the product regardless of the issue. E-mail us with your order information to learn more.

Powered by BBEN Smart Home



Installation video